

LATTY[®] seal B17

A WELDED METAL BELLOWS SEAL
TO DIN 24960
AND AFNOR NF E 29991 STANDARDS



flexible in application: bellows can be stationary or rotary

Operating parameters

Shaft diameters: 20 to 100 mm
Pressure: 20 bar
Temperature: -20 °C to +200 °C
Speed: 25 m/s

Main applications

General service pumps in all industries
Hot or cold, corrosive fluids or slurries
(with appropriate choice of seal faces)

Pressure - Speed - Temperature are not associated

LATTY[®]seal B17

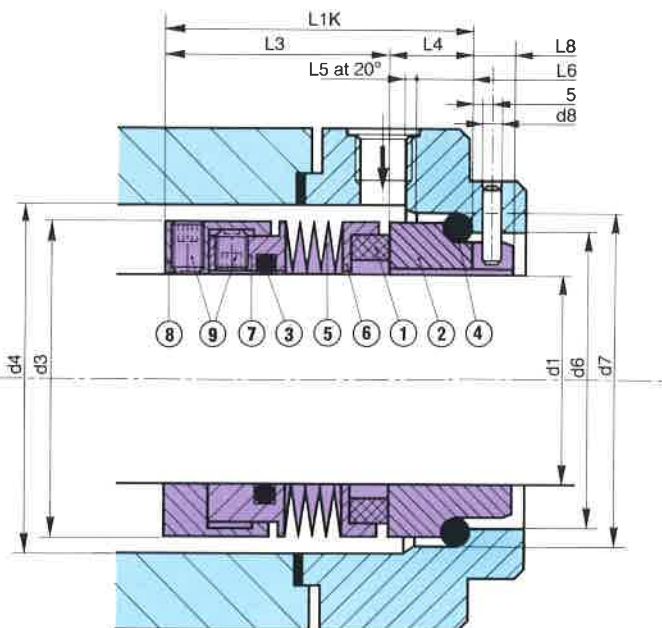

STANDARD DESIGN

Rep.	Designation	Material	Code LI
1	Rotary face	Pure sintered silicon carbide Metal impregnated carbon	U6 A
2	Stationary face	Silicon carbide Ceramic	U3 V
3	O-ring	Viton EP	V E
4	O-ring	Viton EP	V E
5	Welded metal bellows	Steel Carpenter 20 Cb 3	G8
6	Face holder	Steel 329	G3
7	Ring	Steel 329	G3
8	Drive ring	Steel 329	G3
9	Locking screw	Steel 316 L	G1

SPECIAL DESIGNS ON REQUEST

- Factory pre-set cartridge seal
- Shrunk fit silicon or tungsten carbide stationary
- Pure sintered silicon stationary
- Metal parts in "Hastelloy C"
- Seals in LATTYgraf E, KALREZ, CHEMRAZ

Carpenter, Hastelloy, Viton, KALREZ and CHEMRAZ are registered names

FACTORY PRE-SET CARTRIDGE SEAL

Stationary bellows

Rotary bellows

Without quench

Without quench

With quench

With quench

The information given in this document is for guidance only and does not commit LATTY international in any way. LATTY international does not warrant the performance of its products, unless properly fitted and used in accordance with the instructions, nor can accept any claim for consequential liability.



LATTY[®]international
 For the best in modern sealing technique
 1, rue Xavier-Latty - 28160 Brou - France
 Phone (33) 37 47 40 30 - Tx: 760 966 F
 Fax (33) 37 47 82 96

*LATTY, registered trademark LATTY international